

# CONDUCTOMETRIC SENSOR SUBSTRATES

Type : CC1.W\* (\*)

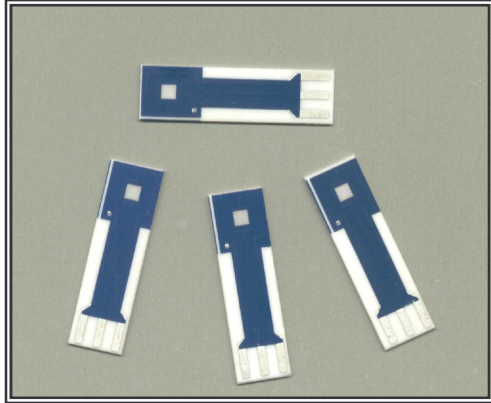

## Description

The sensor is formed on a corundum ceramic base. Onto this surface two interdigitated structures of electrodes are applied. The electrodes are made of Platinum-Gold alloy in standard product CC1.WS. At the end of the sensor there is a contact which is connected with the active part by the silver conducting path which is covered by a dielectric protection layer. A bio-chemically active substance is put on the working electrode of the sensor.

## Physical Parameters

Dimensions		
Length	Width	Thickness
25.40 mm	7.26 mm	0.63 mm

Weight = 0.4 gms

A =  $4,00 \pm 0,05$  mm

B =  $2,00 \pm 0,05$  mm

C =  $2,00 \pm 0,05$  mm

## Electrode Materials

Electrode materials are defined by:

CC1.W\* (\*)

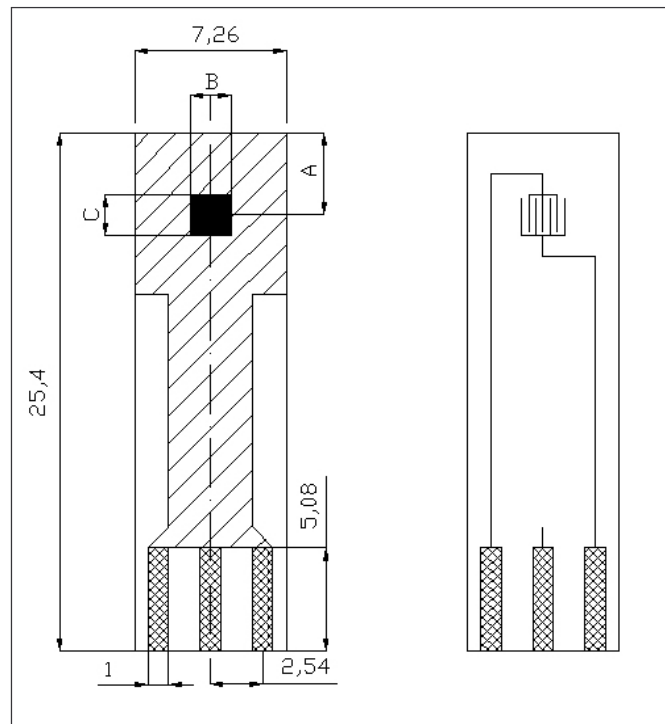

The asterisk is replaced by the appropriate number or letter.

- C - Conductometric sensor
- C - Corundum ceramic base
- 1 - Sensor group reference number
- W - Working electrode material
  - S - Alloy of Gold and Platinum
  - 1 - Pure Gold
  - 2 - Pure Platinum
  - 3 - Pure Silver
  - 4 - Graphite 1 (7101)
  - 5 - Graphite 2 (7105)

- (\*) - Additional technical specification
- S - Sealing
- H - Heating of the sensor
- T - Temperature sensing element

## Connector Types for CC1 Sensor Range

	KA1	KA3	KA4	KA5
CC1.W*.	•		•	
CC1.W*. (S)		•		•
CC1.W*. (H)			•	
CC1.W*. (T)			•	
CC1.W*. (H, T)			•	
CC1.W*. (S, H)				•
CC1.W*. (S, T)				•
CC1.W*. (S, H, T)				•

## Optional Equipment

Evaluating Units:

- CA1 – ASIC for precise conductivity measurement (in development)

Experimental Accessories:

- Flow Changer
- MFS (Micro Flow System)
- Peristaltic Pump
- Stand
- Thermostated Vessel

## Sensor Usage

This specific range of CC1 sensors enables the measurement of:

- Basic electrochemical and bio-electrochemical techniques
- Conductivity analysis

## Software Packs

These are available for:

- Bipolar current pulse measurement

## Related patents

CZ-PV 2001-3227

## Ordering Information

- The order is specified by whole sensor description formula
- Minimum order quantity – 25 sensors
- All order quantities are to be in multiples of 25 e.g. 25, 50, 75, etc.
- Delivery time for standard CC1 sensors is 4 weeks from receipt of order
- Delivery time for non-standard CC1 sensors depends on final technical specification of order

Example of Order:

- 100 pieces – CC1.W2

Standard stock program is black, products available on special order are on shadowed background.

## The explicit list of materials used for electrode preparation

Type of Sensor	Electrode Material	Conducting Paths
	Working	
CC1.WS	PtAu (15 / 85%)	Ag
CC1.W1	AuPd (98 / 2%)	Ag
CC1.W2	Pt (100%)	Ag
CC1.W3	AgPd (98 / 2%)	Ag
CC1.W4	C (7101)	Ag
CC1.W5	C (7105)	Ag