

FLOW CELL

Type: FC9

Description:

The flow cell enables the use of AC9 electrochemical array sensor in a flow through arrangement. The sensor is inserted into the slit of cell and tightened by closing of the door. The cell ensures the reproducible flow around all eight working electrodes. The principle is similar to rotating disc electrode. The delivery contains also the contact and output cable.



Physical Parameters:

Dimensions:

Weight: 108 gms
 Length: 77 mm
 Width: 25 mm
 Thickness: 30 mm

Cell Material:

- Aluminium
- Teflon
- PMMA

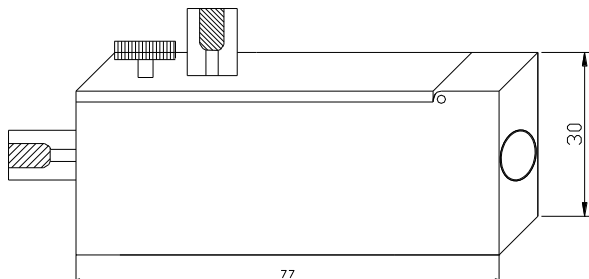

Cell Usage:

- Flow measurement
- Flow-injection analysis

Experimental Accessories:

- Peristaltic Pump
- Linear Pump

Evaluating Units

- Palmsens + CH8 multiplexer - www.palmsens.com

Flow Arrangement (→ liquid flow direction)

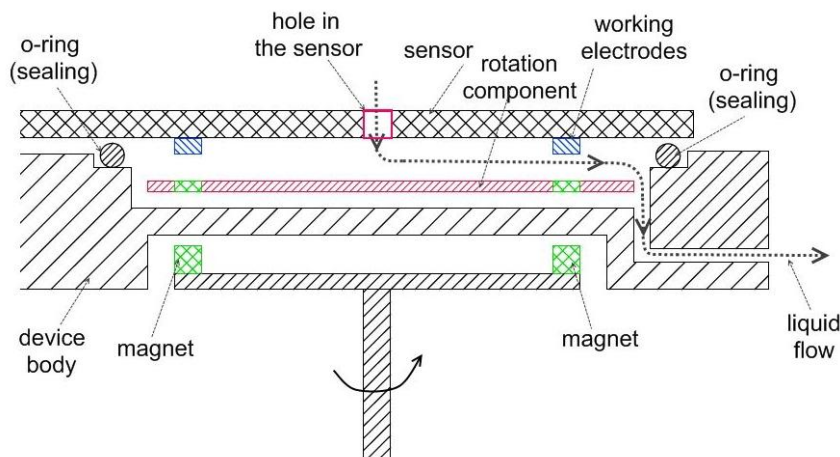

Conversion:

- Analyte conversion on AC9 electrochemical sensor using FC9 cell is approx. 3%.

Reproducibility test on 8 electrodes of AC9 electrochemical sensor

analyte: 1 mM ferricyanide, flow speed: 1 ml/min, applied potential : -100 mV/int. ref

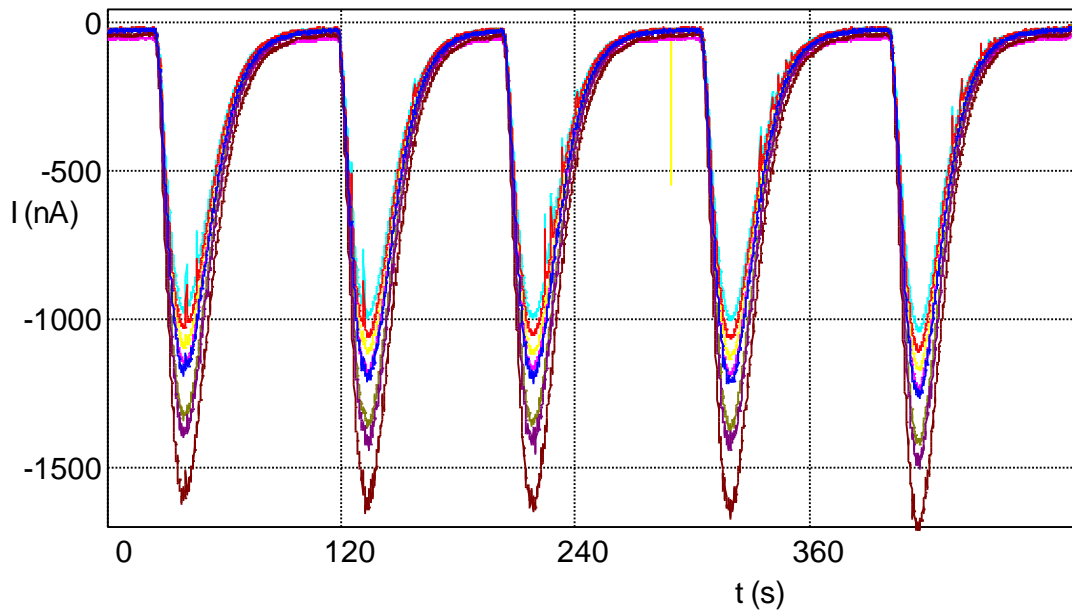

Example of Order

- 5 pieces - FC9

Ordering Information

- The order is specified by whole product code
- Minimum order quantity - 1 cell
- Delivery time for standard FC9 cell is 4 weeks from receipt of order
- Delivery time for non-standard FC9 cell depends on final technical specification of order