

REFERENCE CLASSIC ELECTRODE

Type: RCE.R*.E**

Description

RCE is a glass hollow tube with silver or silver covered by silver chloride wire inside. The tube is hollow with the hole in the wall for inserting KCl solution. Hole is covered by a rubber band. Reference classic electrode (RCE) is designed for measurements with thermostated cell TC2, TC3. Standard cable length of reference classic electrode is 1,5 m. Connector or banana plug color is yellow.



Physical Parameters

Dimensions:

Length: 57 mm
 Diameter: 11mm
 Weight: 50 gms

Electrode material

RCE.R*.E** (Reference Classical Electrode)

R - Reference	E - Electrode ending
C - Classical	S - Bare wire
E - Electrode	1 - Banana plug
R - Electrode material	2 - 7 poles BVT connector
S - Ag covered by AgCl	3 - Triad 01 PalmInstruments
1 - Ag	4 - BNC connector
	5 - Small banana plugs

Ordering Information

- The order is specified by whole product code
- Minimum order quantity - 1 electrode
- Delivery time for standard RCE.R*.E** electrode is 4 weeks from receipt of order
- Delivery time for non-standard RCE.R*.E** electrode depends on final technical specification of order

Example of Order - 10 pieces - RCE.RS.E4

Internal Wiring

RCE.R*.ES

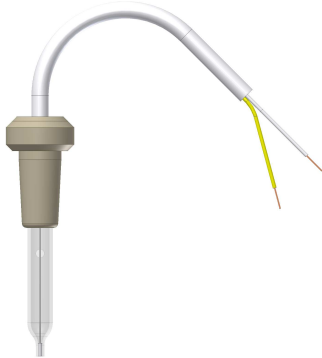

RCE.R*.E1

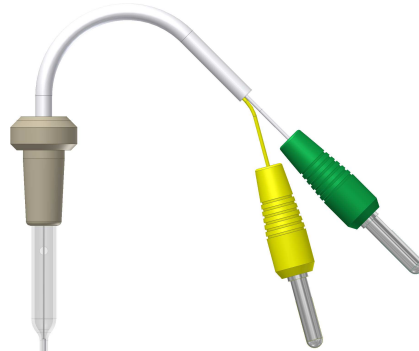

RCE.R*.E2

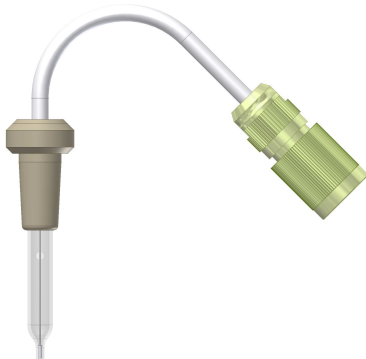

RCE.R*.E3

RCE.R*.E4.

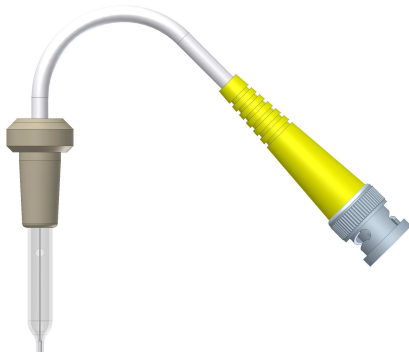

RCE.R*.E5

